

REVISION RECORD

REV	ECN	DESCRIPTION	DRFT	DATE
-----	-----	-------------	------	------

NOTES1:

UL Standard

- 1.Rated Voltage/Current : 300V / 12A
- 2.Withstanding voltage : AC1600V/1Min.
- 3.Torque Value : M2 , 1.77Lb.in
- 4.Wire Range : 30~16AWG

IEC Standard

1. Pollution degree	2	2	3
Overvoltage category	II	III	III
Rate impulse voltage(KV)	2.5KV	2.5KV	2.5KV
Rate voltage(V)	320V	160 V	160 V
Rate current(A)	12A		

- 2.Torque Value : M2 , 0.2N.m
- 3.Wire Range : 0.2~1.5mm²

NOTES2:

- 1.Dimension shall be interpreted per ASME Y14.5-2009
- 2.Pitch : 3.81mm, Poles : N=06~72P
- 3.Stripping length : 5~6mm
- 4.Operating temperature: -40°C~+105°C
- 5.Undimensioned Tolerances:

Pitch range in mm		Nominal dimension range in mm						
TO	Over	TO	Over	TO	Over	TO	Over	
6	10	10	24	30	60	100	150	0.1/10
±0.15	±0.20	±0.30	±0.30	±0.50	±0.70	±1.00	±1.30	±2*

6.RoHS Compliance

DG381A3 - 3.81 - XXP - 1Y - 00A (H)

(Series No.) (Pitch) (Poles) (Single Pitch) (RoHS) 00A-(Standard)

(Color):1.(Grey)2.(Blue)3.(Black)4.(Green)5.(Orange)
6.(Red)7.(Transparent)8.(Yellow)9.(White)

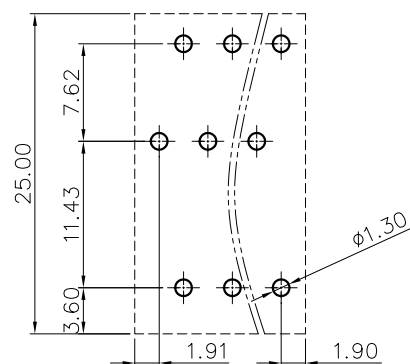
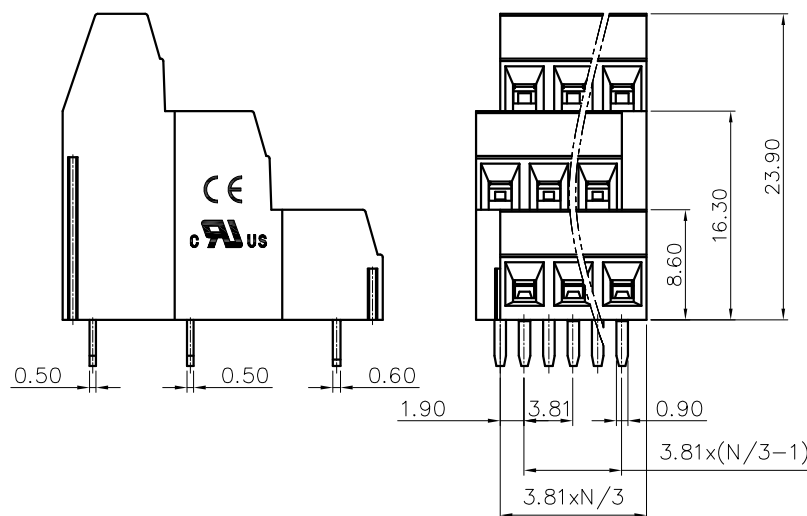
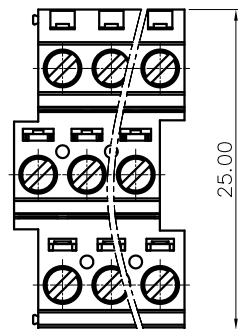

PCB LAYOUT

DETACHED LISTS	PART NO.:	/			宁波高松电子有限公司 NINGBO DEGSON ELECTRICAL CO., LTD		
	APPD:	/			NAME:		
	CHKD:	/			DG381A3-3.81-XXP-1Y-00A(H)		
	DRFT:	/			TITLE: CUSTOMER DRAWING		
				DRAWING NO.:		REV	DO
						SHEET	1/1
				DO NOT SCALE DRAWING		SCALE	1:1