

## SHIELDED SMD POWER INDUCTORS / FPI (S) TYPE

### FEATURES

- ◆ Excellent solderability and high Heat resistance
- ◆ Excellent terminal strength construction
- ◆ Shielded with magnetic resin
- ◆ Closed magnetic design



### APPLICATIONS

- ◆ Power supply for VTRs.
- ◆ Portable communication equipment.
- ◆ Notebook PCs.
- ◆ LCD televisions.
- ◆ DC/DC converters, etc.

### ORDERING CODE

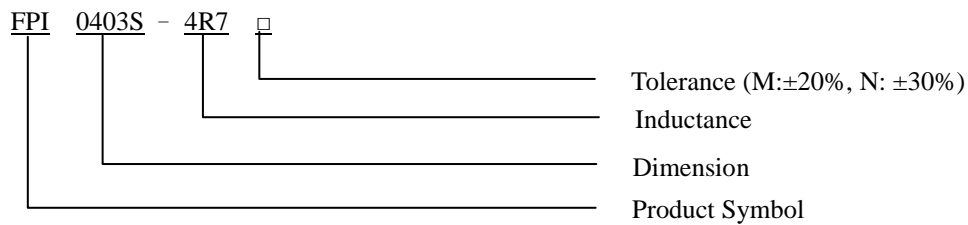

### DIMENSIONS (UNIT: mm)

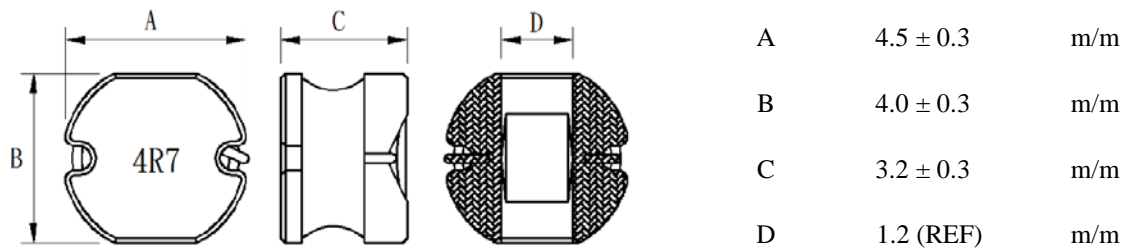

CORE MASTER ENTERPRISE CO., LTD.

<http://www.coremaster.com.tw>



## SHIELDED SMD POWER INDUCTORS / FPI (S) TYPE

### ELECTRICAL CHARACTERISTICS FOR FPI0403S

Part No.	Inductance (uH)	RDC ( $\Omega$ )	IDC (A)
FPI0403S-1R0 □	1.00	0.014	6.00
FPI0403S-1R5 □	1.50	0.020	4.84
FPI0403S-2R2 □	2.20	0.030	4.40
FPI0403S-3R3 □	3.30	0.040	3.30
FPI0403S-4R7 □	4.70	0.060	2.90
FPI0403S-5R6 □	5.60	0.065	2.60
FPI0403S-6R8 □	6.80	0.090	2.45
FPI0403S-100 □	10.0	0.100	1.95
FPI0403S-150 □	15.0	0.190	1.65
FPI0403S-220 □	22.0	0.220	1.30
FPI0403S-330 □	33.0	0.330	1.10
FPI0403S-470 □	47.0	0.440	0.95
FPI0403S-680 □	68.0	0.870	0.72
FPI0403S-101 □	100.0	1.150	0.60

\* Test Frequency : 100KHZ/0.25V