

REVISION RECORD

REV	ECN	DESCRIPTION	DRFT	DATE
-----	-----	-------------	------	------

NOTES1:

UL1059 Standard

- 1.Rated Voltage/Current : 300V / 30A
- 2.Withstanding Voltage : AC1600V/1Min.
- 3.Torque Value : M3 , 4.43Lb.in
- 4.Wire Range : 26~10AWG



IEC Standard

1. Pollution Degree	2	2	3
Overvoltage Category	II	III	III
Rate Impluse Voltage(KV)	4.0KV	4.0KV	4.0KV
Rate Voltage(V)	630V	320V	320V
Rate Current(A)		41A	

- 2.Torque Value : M3 , 0.5N.m
- 3.Wire Range : 0.5~6.0mm²

NOTES2:

- 1.Dimension shall be interpreted per ASME Y14.5-2009
- 2.Pitch : 6.35mm, Poles : N=01~XXP
- 3.Stripping length : 13~14mm
- 4.Operating temperature: -40°C~+105°C
- 5.Undimensioned Tolerances:

Pitch Range In mm			Nominal Dimension Range In mm					-		
	Over 6	Over 10		Over 30	Over 60	Over 100	Over 150	0.1/10		
TO 6	TO 10	TO 24	TO 30	TO 60	TO 100	TO 150				
±0.15	±0.25	±0.20	±0.30	±0.50	±0.70	±1.00	±1.30	±2°		

6.RoHS Compliance

DG107R - 6.35 - XXP - 1Y - 00A (H)
(Series No.) (Pitch) (Poles) (Single Pitch) (Color):1.(Grey)
(RoHS)
00A-(Standard)
2.(Blue)
3.(Black)
4.(Green)
5.(Orange)
6.(Red)
7.(Transparent)
8.(Yellow)
9.(White)

DETACHED LISTS	PART NO.:	/				宁波高松电子有限公司 NINGBO DEGSON ELECTRICAL CO., LTD			
	APPD:	/				NAME: DG107R-6.35-XXP-1Y-00A(H)			
	CHKD:	/				TITLE: CUSTOMER DRAWING			
	DRFT:	/				DRAWING NO.: /		REV	DO
	THIRD ANGLE PROJECTION				DRAWING NO.: /		SHEET	1/1	
				MM (INCH)	DO NOT SCALE DRAWING		SCALE	1:1	

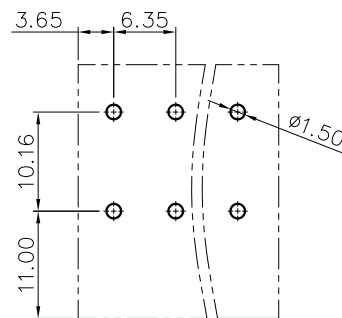
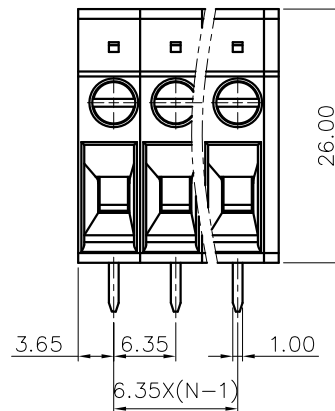
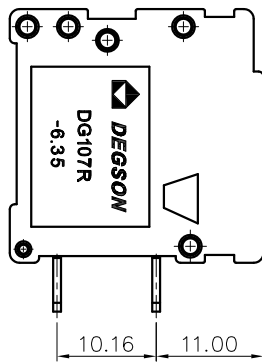
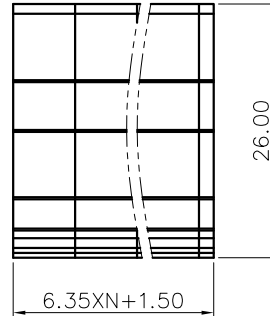

PCB LAYOUT

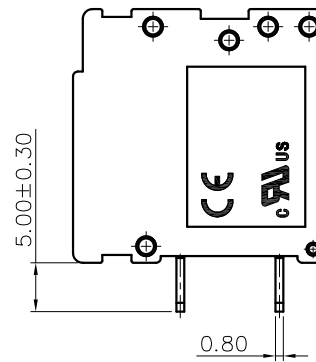

DG107R - 6.35 - XXP - 1Y - 00A (H)
(Series No.) (Pitch) (Poles) (Single Pitch) (Color):1.(Grey)
(RoHS)
00A-(Standard)
2.(Blue)
3.(Black)
4.(Green)
5.(Orange)
6.(Red)
7.(Transparent)
8.(Yellow)
9.(White)